

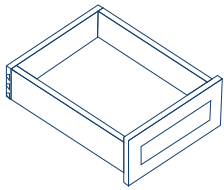

FRAMELESS CABINET STANDARD FEATURES

- All doors are pre-hung with concealed adjustable hinges
- Cabinet sides are combined 3/4" thick particleboard
- Adjustable shelves are 3/4" thick particle board, 5mm holes for shelf support
- Drawers are constructed with 3/4" thick particleboard drawer sides
- Toe kicks are 1/2", and 4 1/2" high
- Standard drawer slides, epoxy-coated, self-closing (not soft closing)
- Custom sizing is available



Drawer Box Feature

All drawers are constructed with 3/4 inch material to match door



Hinge Feature

Concealed adjustable hinges, to enhance the beauty of the cabinet



Drawer Slide Feature

Drawer slides are epoxy coated, double-captive side mount drawer guides



Door Feature

3/4" thick MDF core. Slab & Other Styles are available upon request.

Option to use either a Solid Wood Shaker door, Solid Wood Slab Door, MDF core with a Wood veneer door, Thermofoil door, Melamine or Laminate door on a Frameless box.

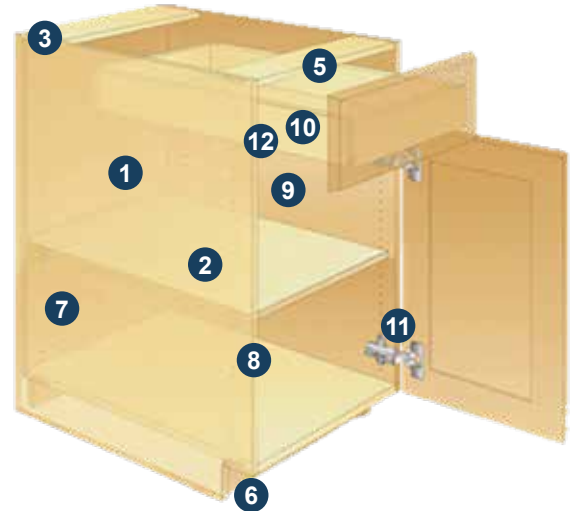

1. Cabinet sides are 3/4" thick.
2. All cabinet backs are 1/4" dadoed into the sides
3. Flush bottom, top and finished ends for a furniture like appearance.
4. Optional foot moldings and light rails secure to flush tops and bottoms of wall cabinets.
5. Full width 3/4 inch stretchers front and rear provide solid support and mounting surface for counter tops.
6. Toe kicks are 1/2" thick birch plywood, and 4 1/2" high
7. Back - 3/4" thick material at H Frame
8. Front edges have a PVC edge banding
9. Interior is to match door color or white
10. Drawers are constructed with 3/4 inch material drawer sides
11. Concealed adjustable hinges, to enhance the beauty of the cabinet and are adjustable.
12. Standard drawer slides, epoxy coated, self-closing.

